

MyBabiie®

For little people who dream big

MB160 Pushchair Instructions



IMPORTANT - READ CAREFULLY AND KEEP FOR FUTURE REFERENCE

Get to know your MB160 Pushchair

Scan the QR code below on your camera app to be linked off to our page to get all the information you need for using your MB160 Pushchair. From setting it up to how to fold it down, it's all there!



SCAN ME



SAFETY & CARE NOTES

IMPORTANT - READ CAREFULLY AND KEEP THESE INSTRUCTIONS FOR FUTURE REFERENCE

Remove all packaging and non-permanent labels and dispose of safely before using this product. The safety of your child could be put at risk if you do not follow these instructions. This stroller is designed for 1 child from 0 months up to a weight of 22 kg.

WARNING: Never leave the child unattended.

WARNING: Uneven or excessive loading of items on or in the stroller may cause the product to tip and may cause injury.

WARNING: Maximum intended weight within the shopping basket is 3kg.

WARNING: Ensure that all the locking devices are engaged before use.

WARNING: To avoid injury ensure that the child is kept away when unfolding and folding this stroller.

WARNING: Do not let the child play with this product.

WARNING: Always use the restraint system.

WARNING: Check that the stroller body is correctly engaged before use.

WARNING: Do not put hot drinks or liquids in the cup holder.

WARNING: This product is not suitable for running or skating.

WARNING: Do not insert any additional mattresses into the stroller.

WARNING: Accessories which are not approved by the manufacturer shall not be used.

WARNING: This pushchair has been designed for one child and shall be used for the transport for only one child!

WARNING: Always use the crotch strap in combination with the waist belt.

WARNING: This stroller does not replace a cot or a bed. Should your child need to sleep, then it should be placed in a suitable cot or bed.

WARNING: Only replacement parts supplied or recommended by My Babiie shall be used.

WARNING: Any load attached to the handle and on the back of the backrest and on the sides of the stroller will affect the stability of the stroller.

WARNING: The parking device shall be engaged when placing and removing the children.

EN 1888-1:2018+A1:2022 and EN 1888-2:2018+A1:2022 approved

Care and Maintenance

- Please check on a regular basis that the brakes, wheels, latches, connecting elements, belt systems and seams are properly functional.
- Do not expose the stroller to strong sunshine.
- Sponge clean only.
- After use in rain or snow, the wheels should be lubricated and the stroller dried to prevent rust.
- Care for, clean and check this stroller regularly.

Your child's safety is your responsibility

If you have a problem with this product or require replacement parts, please visit www.mybabiie.com/support

Register your product at: www.mybabiie.com/warranties

WHAT'S IN THE BOX



1. Bumper bar
2. Cup holder
3. Canopy
4. Frame
5. Rear wheels (x2)
6. Front wheels (x2)

ASSEMBLY INSTRUCTIONS

Opening the pushchair

- Unhook the latch on the outside of the stroller as shown below, while pulling the handle with your other hand to unfold the stroller.
- Push the lock to the outside of the stroller as shown below and at the same time pull up the handle with the other hand to unfold the stroller.

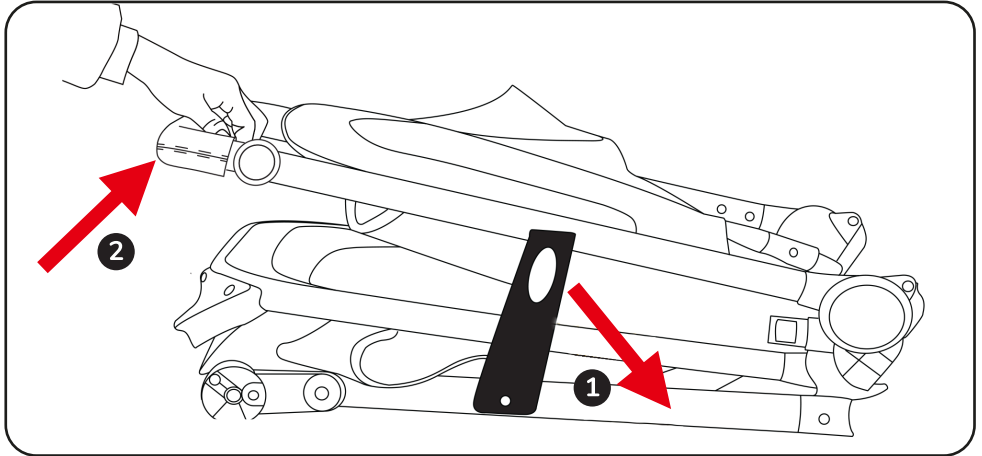

- When the stroller is opened, you should hear "click" sounds on both sides of the stroller, please examine if the stroller is locked in safety position before you use it.

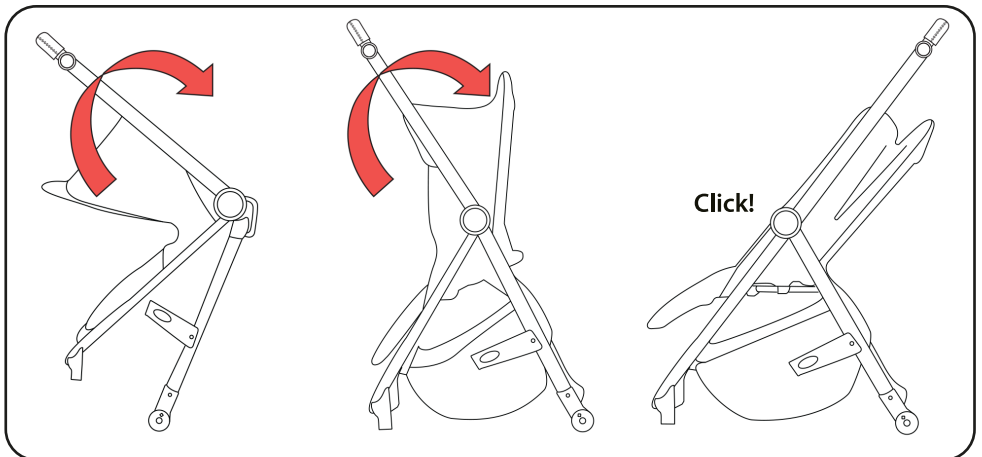

ASSEMBLY INSTRUCTIONS

Attaching the bumper bar

Insert the bumper on both sides of the seat as shown. Note: Please make sure to lock the bumper in place when you heard a "click" sound.

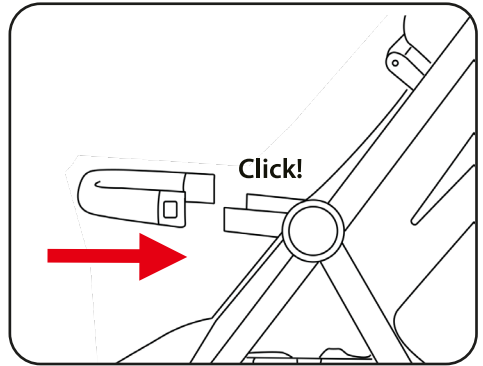

Attaching the hood

Insert the hood plastic into the seat as shown.

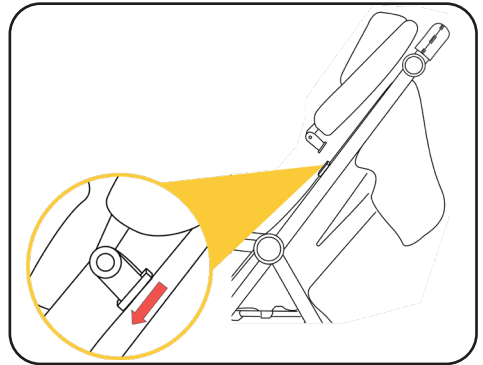

Attaching the front wheels

Take out the front wheels, insert the vertical shaft into the plastic hole on the wheel seat as shown, until it is locked, install the other side of the front wheel in the same way.

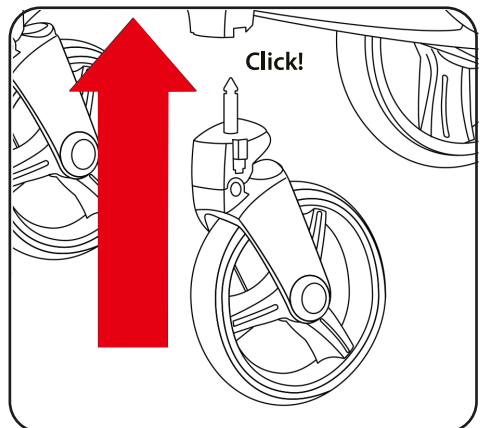

ASSEMBLY INSTRUCTIONS

Attaching the rear wheels

Take one side of rear wheels, Insert the rear axle into the plastic hole as shown, until it is locked, install the other side of the rear wheel in the same way.

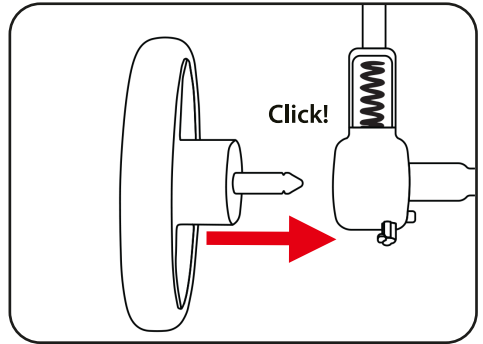

The bumper bar can be detached on one side and rotated up or down to make getting the child in or out the pushchair easy. Push the bottom on the side of the bumper bar to release it.

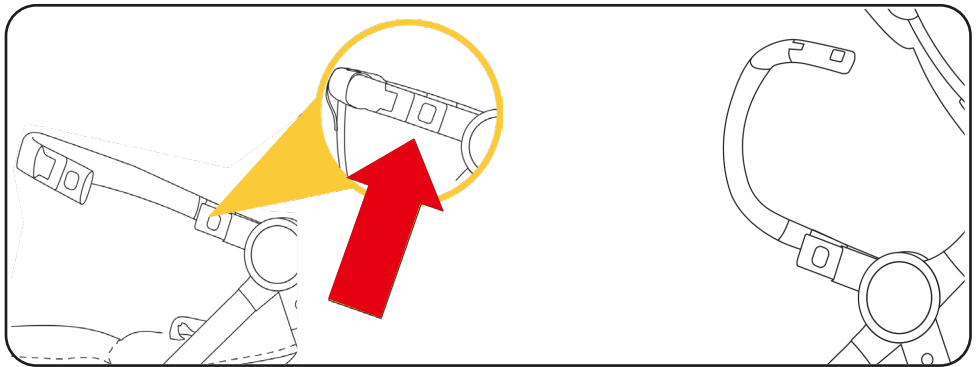

The canopy can be fully extended as shown.

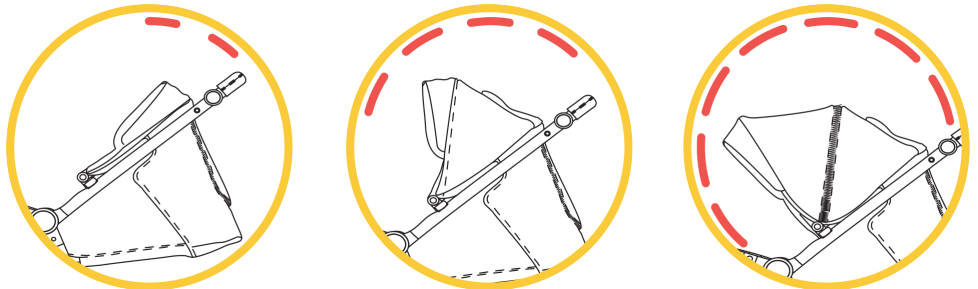

ASSEMBLY INSTRUCTIONS

Adjusting the backrest

Pull up the plastic button on the back of the backrest and adjust the backrest to any of 3 available positions (sleeping or seated).

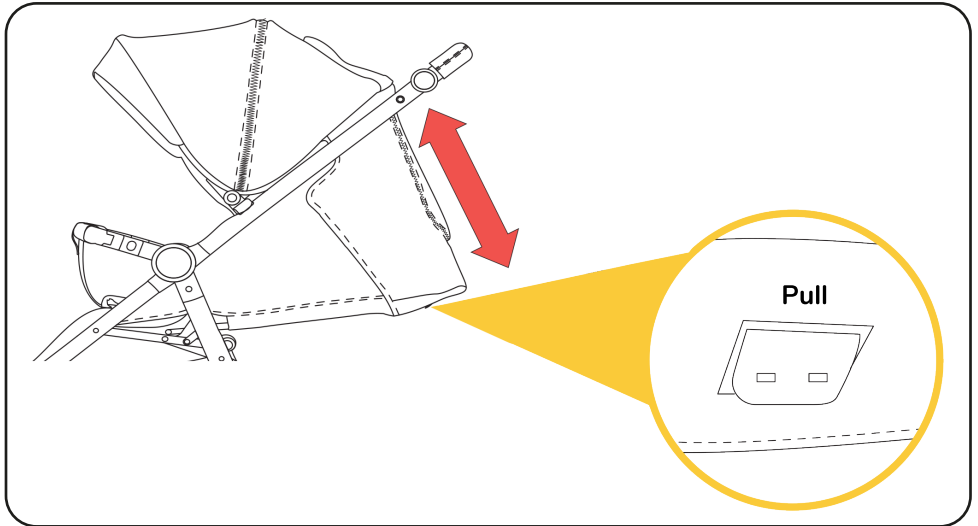

Swivel front wheels

Lift up the plastic button on the front wheels to lock the wheels in position, press down the plastic button to release it so the wheel can be rotated 360 degrees.

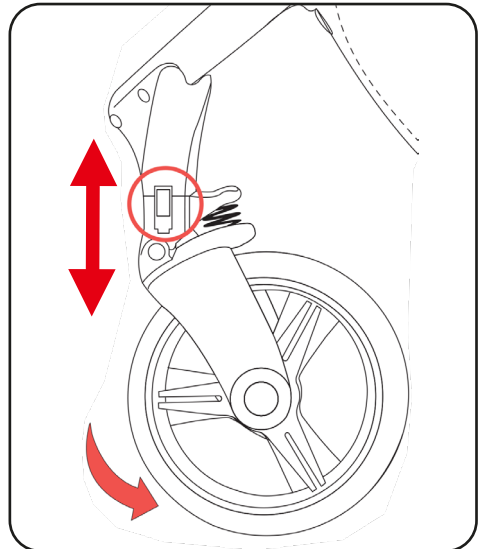

ASSEMBLY INSTRUCTIONS

Releasing the front wheels

Press the small metal pins, at the same time use your hand to pull out the front wheel.

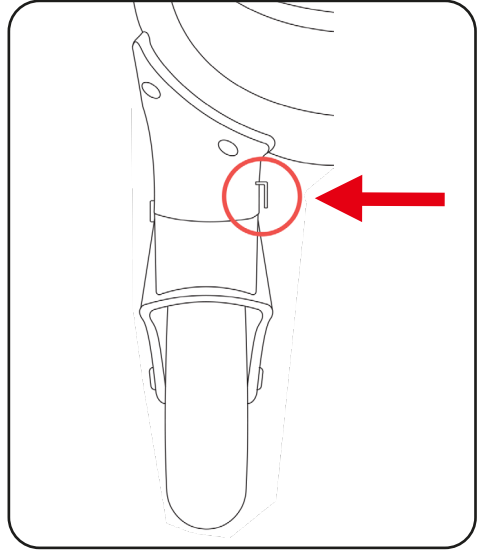

Releasing the rear wheels

Pull the rear wheel release catch down, remove the rear wheel in the direction of arrow left.

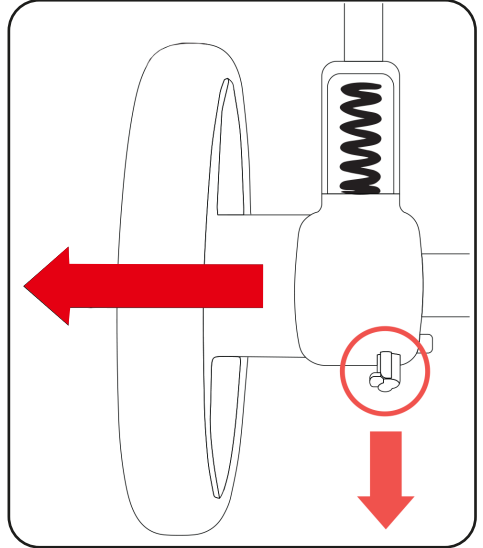

ASSEMBLY INSTRUCTIONS

Using the brake

Step down the brake pedal to brake the stroller, lift up the pedal to release the brake.

Warning: Always lock the brake when putting in or taking out the child!

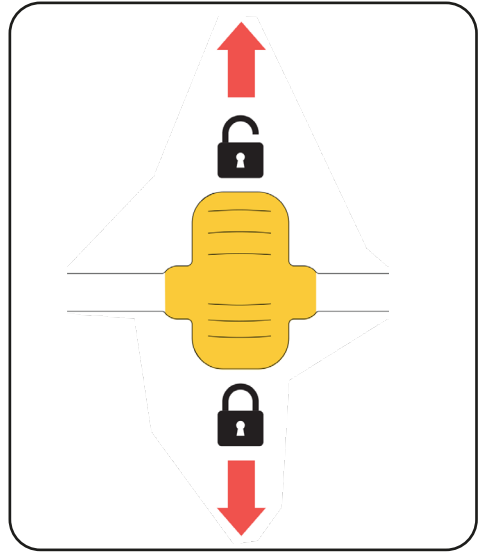

Using the leg rest

Pull the button on the side of the leg rest to adjust the footrest. There are 3 footrest positions.

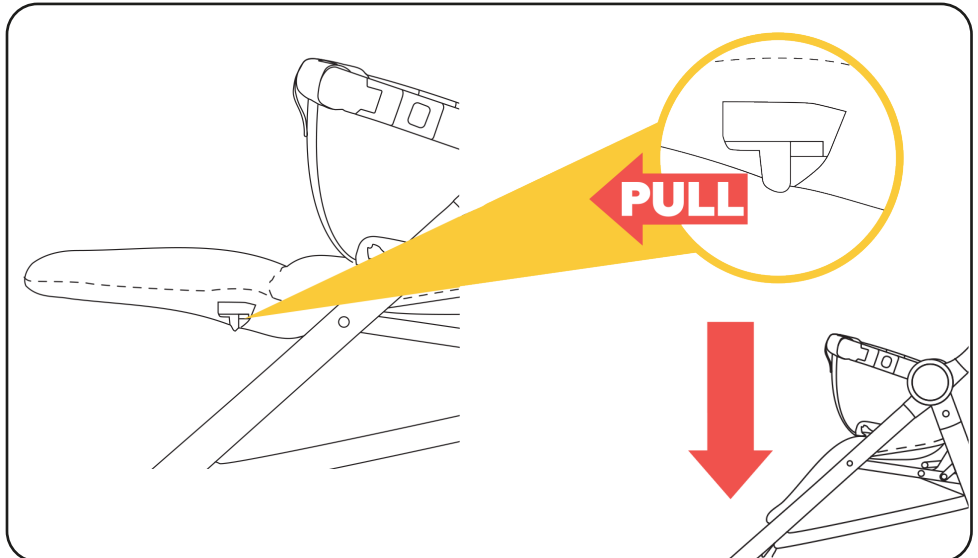

ASSEMBLY INSTRUCTIONS

Folding the pushchair

Press the second lock and at the same time press the folding button on the handle as shown (b) to unlock the stroller, then push the handle forward (c). With your other hand grab the folding tube under the seat as shown (d), pull the stroller up by holding the folding tube under the seat to fold the stroller.

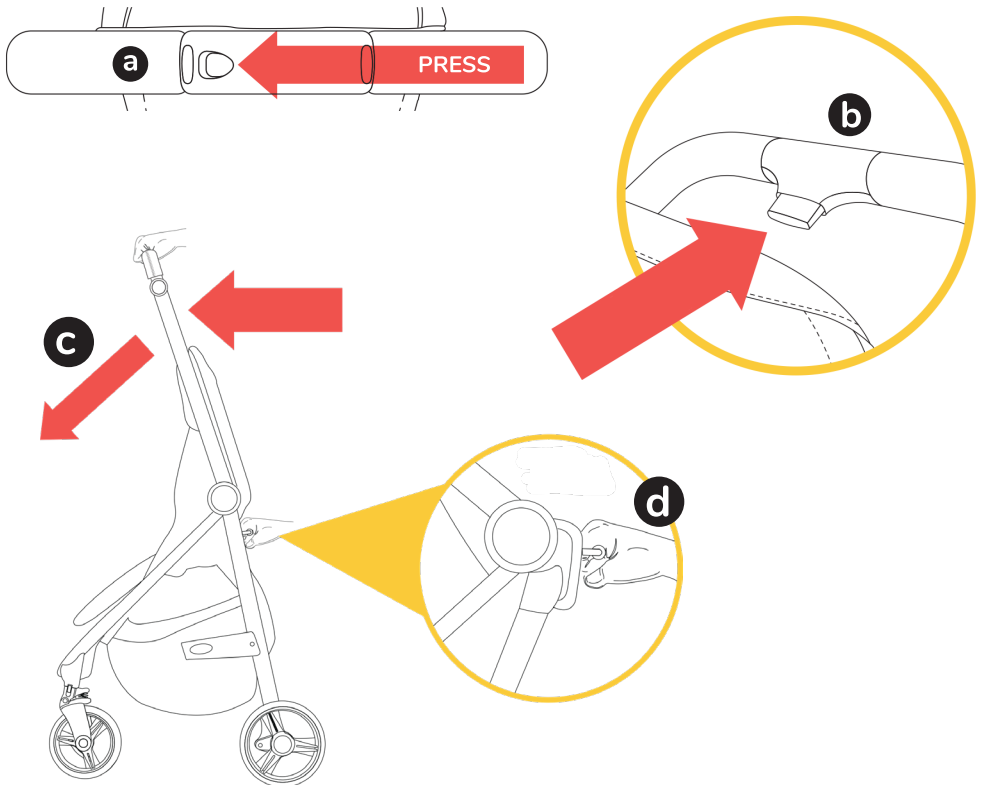

ASSEMBLY INSTRUCTIONS

Folding the pushchair

After the stroller is fully folded the folding lock will automatically lock the pushchair into the closed position.

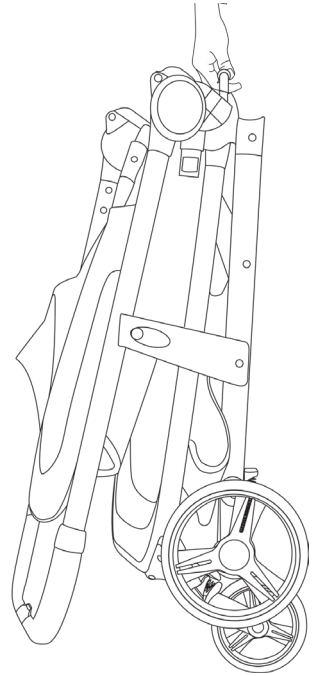
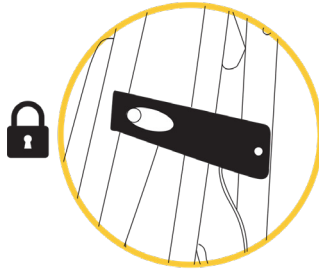

Using the harness

Click the buckles together to lock together the safety belt on both sides.
Press the middle button to release the safety harness buckles.

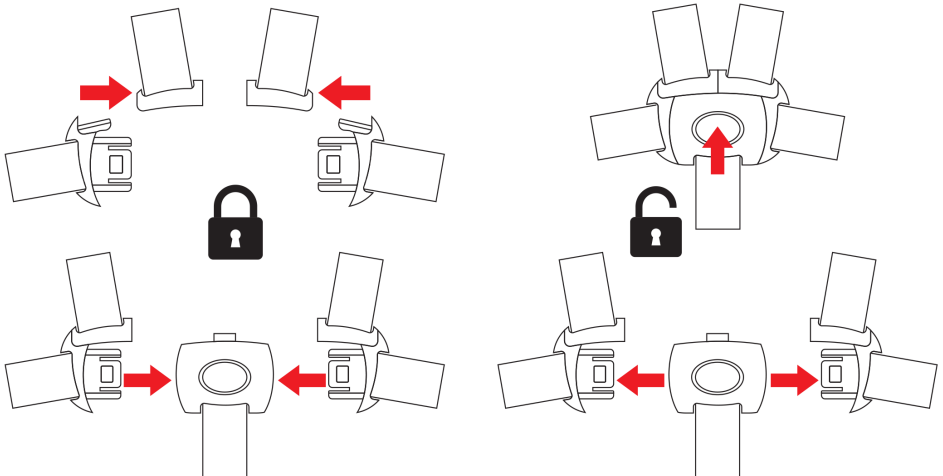

Pushchair do's & don'ts



Do use your brakes!

Ensure the parking brake is engaged during the loading and unloading of children & when the pushchair is stationary.

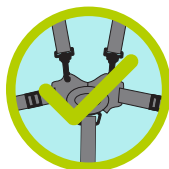

Do always use the restraint system!

Ensure that the child restraint system is correctly fitted at all times.



Do keep your pushchair clean and dirt free.

Use a clean white cloth, warm water and a mild detergent to keep your pushchair clean.

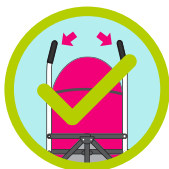

Do always keep two hands on the handles when pushing.

You could lose control of your pushchair if not steering with both hands.



Do follow manufacturers instructions when assembling and using your pushchair.

For safety, please refer to our instruction manuals or contact customer support if you're unsure.



Don't use your pushchair up and down stairs!

Don't use your pushchair up or down stairs or to bump kerbs.



Don't hang bags off the handles!

Bags and other items should not be hung from the handles as this can affect the stability of the pushchair.



Don't run or skate with your pushchair!

Our products are not suitable for running or skating.



Don't carry the stroller with baby inside!

Our pushchairs are not designed to be carried with your baby inside them.



Don't put hot drinks in the cup holder.

Hot drinks burn and can easily spill from the bottle holder.



Don't jetwash your pushchair.

Some jet washers are very powerful and could damage parts of your pushchair!



Don't leave your child un-attended in their pushchair.

Always keep your child and pushchair in view to avoid accidents.



Don't treat your pushchair like a trolley.

Don't load your pushchair up with all your shopping as they are not built for this purpose and could cause damage.



Don't use your pushchair as a bumper cart!

Damage can easily occur if your pushchair is knocked into other things.



Don't smoke around your pushchair.

We wouldn't want your pushchair or little one getting hurt or damaged!



Don't leave your pushchair unattended on extreme gradients.

Even with your brakes on your pushchair is at risk from tipping or sliding on extreme gradients!



Don't sit in the pushchair unless the user is under the guideline weight.

Our pushchairs are designed to hold a maximum weight. If exceeded this will cause damage!



Do enjoy your My Babie product!

Go out and have fun adventures with your little one!

MyBabiie®

For little people who dream big

REGISTER YOUR PRODUCT AT

www.mybabiie.com/warranties

**In the first instance of needing assistance please
contact your original place of purchase.**

This product qualifies for 12 month warranty
when registered through our website

STAY CONNECTED!



My Babiie



@MyBabiieOfficial



My Babiie



@MyBabiie



@mybabiie_official

My Babiie Ltd
Paddock Wood, Kent, TN12 6EN

My Babiie EU
Generaal Vetterstraat 76A, 1059 BW Amsterdam, The Netherlands