

MyBabiie®

For little people who dream big

My Babiie iSize Car Booster Seat

Designed for children height from 135-150cm

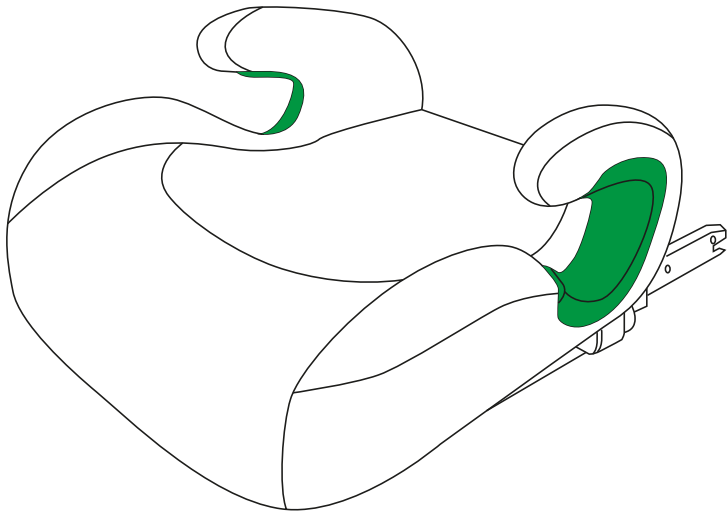

IMPORTANT! KEEP FOR FUTURE REFERENCE

WARNING

This is a Universal booster cushion Enhanced Child Restraint System. It is approved according to UN Regulation No.129, for use in i-Size compatible and universal vehicle seating positions as indicated by vehicle manufacturer in the vehicle user's manual. If in doubt, consult the Enhanced Child Restraint System manufacturer or the retailer. In order to provide your child with greatest security, please read this instruction manual carefully:

- The rigid items and plastic parts of an Enhanced Child Restraint System shall be so located and installed that they are not liable, during everyday use of the vehicle, to become trapped by a movable seat or in a door of the vehicle.
- Any straps holding the restraint to the vehicle should be tight, any support-leg should be in contact with the vehicle floor, any straps or impact shields restraining the child should be adjusted to the child's body, and straps should not be twisted.
- It is important to ensure that any lap strap is worn low down.
- It is dangerous to make any alterations or additions to the device without the approval of the Type Approval Authority, and it is also dangerous not following closely the installation instructions provided by the Enhanced Child Restraint System manufacturer.
- Be sure that children are not left in their Enhanced Child Restraint System unattended.
- Be sure that any luggage or other objects liable to cause injuries in the event of a collision shall be properly secured.
- Be sure that the Enhanced Child Restraint System shall not be used without the cover.
- Be sure that the Enhanced Child Restraint System cover should not be replaced with any other than the one recommended by the manufacturer, because the cover constitutes an integral part of the restraint performance.

IMPORTANT

DIRECTION	SIZE RANGE	INSTALLATION METHOD	TYPE
Forward facing	135-150cm	ISOFIX + 3-point belt	Universal booster cushion
Forward facing	135-150cm	3-point belt	Universal booster cushion

WARNING

Only suitable if the approved vehicles are fitted with 3 point safety belts, approved to UN/ECE Regulation No.16 or other equivalent standards.

- ① Diagonal belt
- ② Lap belt

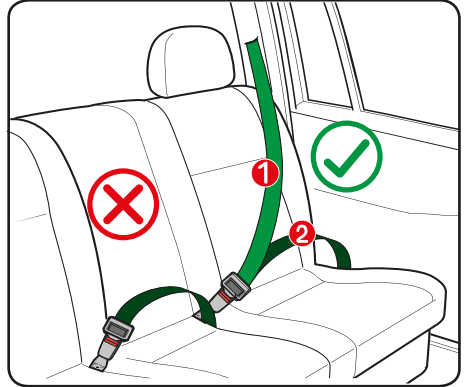



The vehicle rear seat is the safest position for children under 12 years old. This child seat must be installed forward facing.

Rearward facing and sideward facing is strictly prohibited.

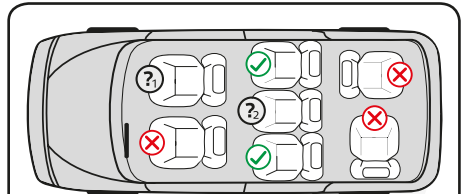
Do not install the child safety seat in the front seat with an air bag.



-  You can install in this position
-  Unable to install in this position
- ① Do not install the child safety seat at the front with an airbag
- ② Only with the three point safety belt can you use this location

SAFETY NOTICE

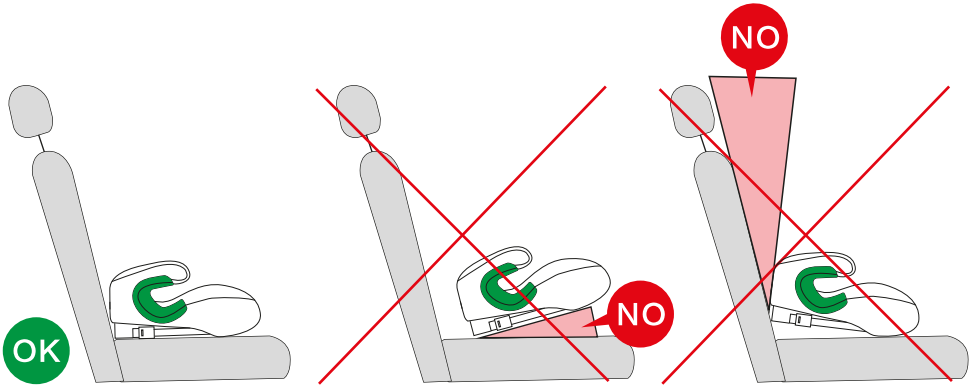

Check whether the safety seat is installed correctly. Proper installation is crucial to ensure the safety of children. The fixing of the child seat must follow the instructions on the belting stickers located on both sides of the seat or the instructions in the manual.

Move the front seat as far forward as possible to ensure that the baby's legs have a comfortable space for movement.

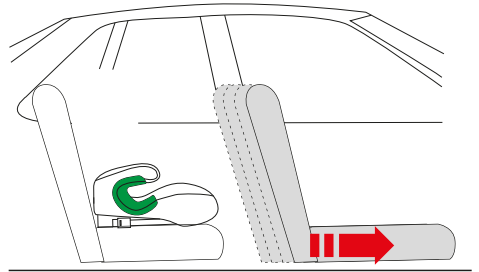

KNOW YOUR CAR SEAT

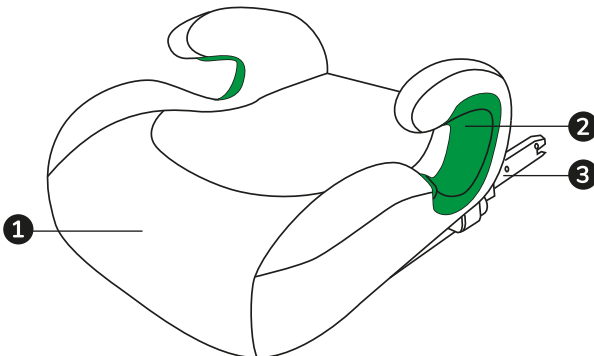

- 1 Base
- 2 Belt guidance
- 3 ISOFIX connector

INSTALLATION METHOD

ISOFIX+3 point safety belt

Applicable to vehicles equipped with ISOFIX system that meets the requirements of ECE R14

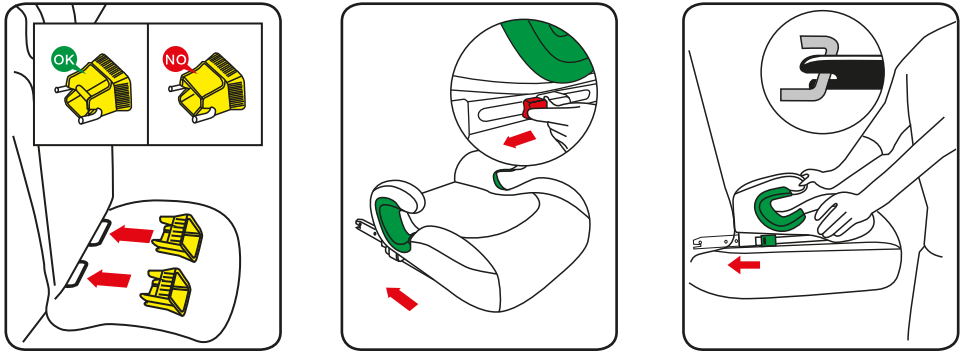

- 1). Find the ISOFIX fixed anchorage point on the car and clip the two guide sleeves to the two ISOFIX fixed anchorage points of the car to facilitate subsequent installation.
- 2). Press and hold the ISOFIX unlock button while sliding outwards to adjust the ISOFIX connectors on both sides of the anchorage seat to the longest state.
- 3). Connect the ISOFIX connector of the anchorage seat to the ISOFIX anchorage point of the car until you hear a "click" sound.

Tip: For the location of the ISOFIX fixed anchorage point, please check your car's user manual or contact your car manufacturer or local dealer.

INSTALLATION METHOD

ISOFIX+3 point safety belt

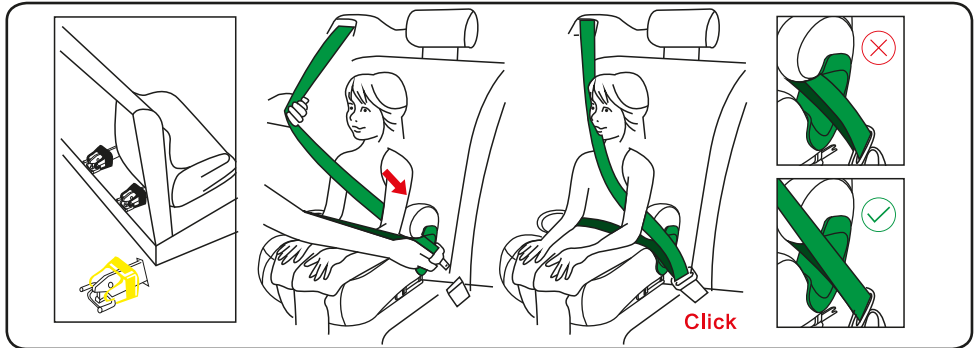

1). Adjust the length of the safety belt guide hook. The shoulder belt of the car safety belt must pass through the guide hook and the top of the armrest, and the waist belt must pass through the guide groove.

2). Let the child sit on the safety seat and adjust the length of the safety belt guide hook according to the baby's height.

3). Pull out the car three-point safety belt, the shoulder belt of the safety belt passes through the guide hook and the top of the armrest, the abdominal belt of the safety belt passes through the guide grooves on both sides of the safety seat, and is fixed to the car buckle, and you hear "Click" sound to ensure that the buckle is firmly locked.

4). Recycle and tighten the car seat belt, and adjust the tightness of the car seat belt according to the size of the child, and it must not be turned over or twisted. Please make sure that the position of the seat belt waistband is as low as possible, so that the child's pelvis can be better fixed.

INSTALLATION METHOD

3 point safety belt

Applicable to vehicles equipped with ISOFIX system that meets the requirements of ECE R14

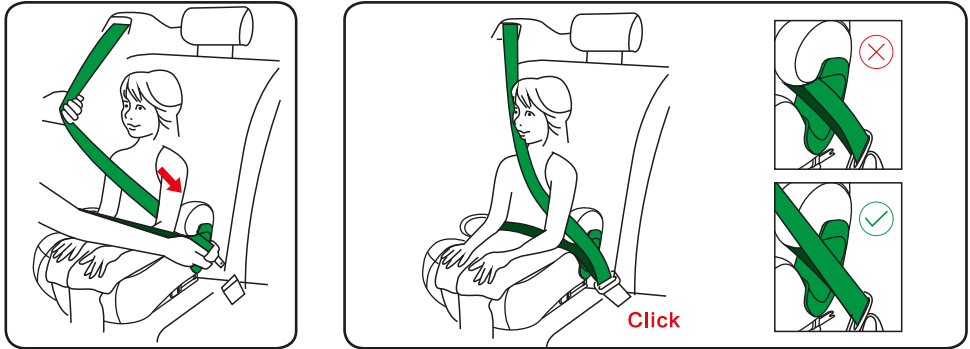

1). Ensure that the ISOFIX connector of the safety seat is retracted into the base, and place the safety seat on both sides of the rear row.

2). Let the child sit on the safety seat and adjust the length of the safety belt guide hook according to the baby's height.

3). Pull out the car three-point safety belt, the shoulder belt of the safety belt passes through the guide hook and the top of the armrest, the abdominal belt of the safety belt passes through the guide grooves on both sides of the safety seat, and is fixed to the car buckle, and you hear "Click" sound to ensure that the buckle is firmly locked.

4). Recycle and tighten the car seat belt, and adjust the tightness of the car seat belt according to the size of the child, and it must not be turned over or twisted. Please make sure that the position of the seat belt waistband is as low as possible, so that the child's pelvis can be better fixed.

REMOVING THE CAR SEAT

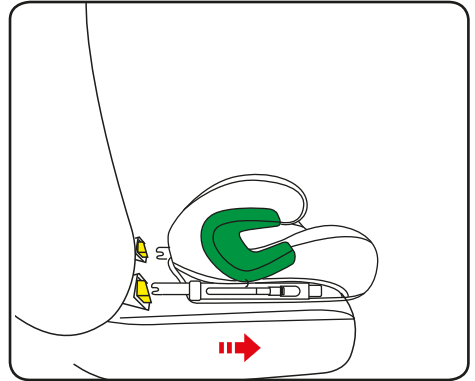
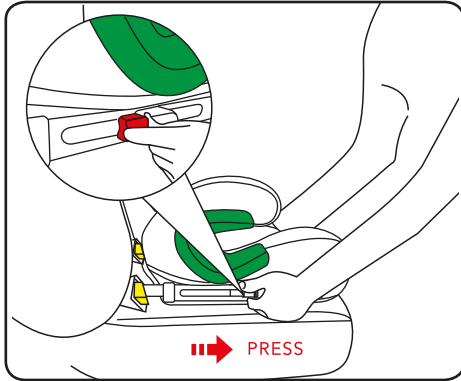

- 1). Press and hold the ISOFIX unlock switch on both sides at the same time. At this time, the ISOFIX lock indicator turns red, which means it is unlocked.
- 2). Pull the safety seat outwards to remove the safety seat.

SEAT MAINTENANCE

Daily maintenance

- In daily use, check the child seat periodically.
- The child seat should be replaced after an accident.
- Please keep this child seat in a dry and ventilated place to avoid it getting damp and moldy.
- If the child seat becomes dusty, clean the seat belt and the plastic pieces by wiping them with a damp sponge and let it dry naturally.
- If food or drink drop accidentally on the buckle, disassemble the seat belt from the child seat and rinse it gently with warm water. Leave it to dry naturally.

Washing instructions

Never use any solvent, chemical detergent or lubricant on any part of your child seat.
Hand wash, water temperature below 30°C.
Do not bleach, tumble dry or iron.

Remove and assemble the fabric cover

- 1). Simply separate the cloth cover from the base.

⚠ The cover is a safety feature. Never use the child car seat without it.

MyBabiie®

For little people who dream big

REGISTER YOUR PRODUCT AT

www.mybabiie.com/warranties

**In the first instance of needing assistance please
contact your original place of purchase.**

This product qualifies for 12 month warranty
when registered through our website

STAY CONNECTED!



My Babiie



@MyBabiieOfficial



My Babiie



@mybabiie_official

My Babiie Ltd

Repton Manor, Repton Avenue, Ashford, Kent, TN23 3GP