

# MyBabiie®

For little people who dream big

## My Babiie iSize Booster Seat

For infants of height ranges from 100cm to 150cm

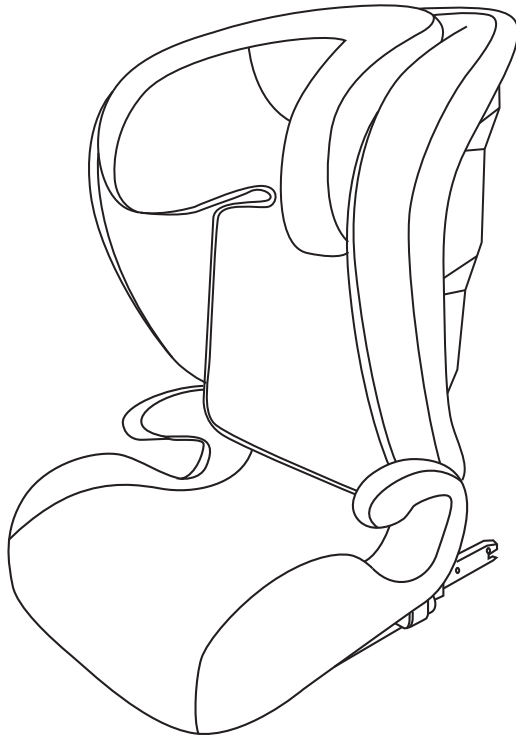

**IMPORTANT! KEEP FOR FUTURE REFERENCE**

# NOTICE

---

**This is a i-Size booster seat Enhanced Child Restraint System. It is approved according to UN Regulation N0.129, for use primarily in i-Size seating positions as indicated by vehicle manufacturers in the vehicle users' manual.**

**If in doubt, consult either the Enhanced Child Restraint System manufacturer or the retailer .**

For your child's safety please read these instructions carefully before use and keep them for future reference. Failure to follow the instructions contained in this manual could result in serious injury to your child.

- Do not use this child safety seat at the home. It has not been designed for home use and should only be used in your car.
- Never leave your child unattended in the child restraint system even for a short time.
- The child safety seat should be changed when it has been subject to violent stresses in an accident.
- This child restraint should be securely belted in the vehicle even when not in use. In a crash or sudden stop, an unsecured child safety seat may injure other occupants.
- Always make sure that any straps holding the seat restraint to the vehicle shall be tight. Any straps restraining the child should be adjusted to the child's body. Check that the straps are not twisted.
- IMPORTANT! Ensure that any lap straps are worn low down, so that the pelvis is firmly engaged.
- Do not use any load bearing contact points other than those described in the instructions and marked in the child restraint, when in doubt, please contact the child restraint manufacturer.
- Any luggage or other objects liable to cause injuries in the event of a collision should be properly secured.
- The rigid items and plastic parts of a child restraint must be so located and installed so that they are not liable during everyday use of the vehicle to become trapped by a moveable seat or in a door of the vehicle.
- To prevent from the risk of fall, your child should always be fastened.
- It is dangerous to make any alterations or additions to the device without the approval of the competent authority and a danger of not following closely the installation instructions provided by the child restraint manufacturer.
- This child safety seat is designed for children from 100-150cm.
- The child restraint must not be used without the cover.
- The seat cover should not be replaced with any other than the one recommended by the manufacturer because the cover constitutes an integral part of the restraint performance.
- Before you adjust any movable or adjustable parts of your child safety seat, you must remove your baby from the child safety seat.
- In hot weather the plastic and metal parts will become hot. You should cover the seat when the car is parked under the sun.

# NOTICE

- We advise strongly that you do not use a second hand product because you cannot be certain it is in good condition.
- Notice: Do not use in any configuration not shown in the instructions.
- Important! Before using ISOFIX child restraint system, please carefully read the manual of automobile manufacturer about the instruction of ISOFIX fix point.
- If the position of the adult safety-belt buckle relative to the main load bearing contact points on the child safety seat is unsatisfactory please contact the manufacturer if in doubt.
- The child restraint may not fit in all approved vehicles when used in stature range above 135 cm.

GROUP	TYPE
100-150cm	i-Size booster seat

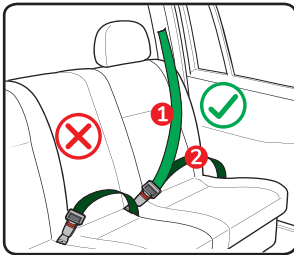

## WARNING

Only suitable if the approved vehicles are fitted with 3 point safety belts.approved to UN/ECE Regulation No.16 or other equivalent standards.

- ① Car belt - Diagonal belt
- ② Car belt - Lap belt

The vehicle's rear seat is the safest position for children under 12 years. This child seat must be installed forward facing. Rearward facing and sideward facing is strictly prohibited. Do not install the child safety seat in the front seat with an airbag.

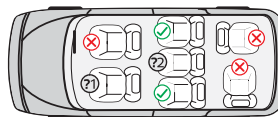

- ✓ You can install here
- ✗ Unable to install here
- Ⓜ Do not install the child safety seat at the front seat with an air bag
- Ⓜ Only with the three point safety belt

## WARNING

Please read the instruction manual carefully before use. Incorrect installation could cause serious injury. If in this case,the manufacturer shall not be responsible for any kind of responsibility.

# NOTICE

---

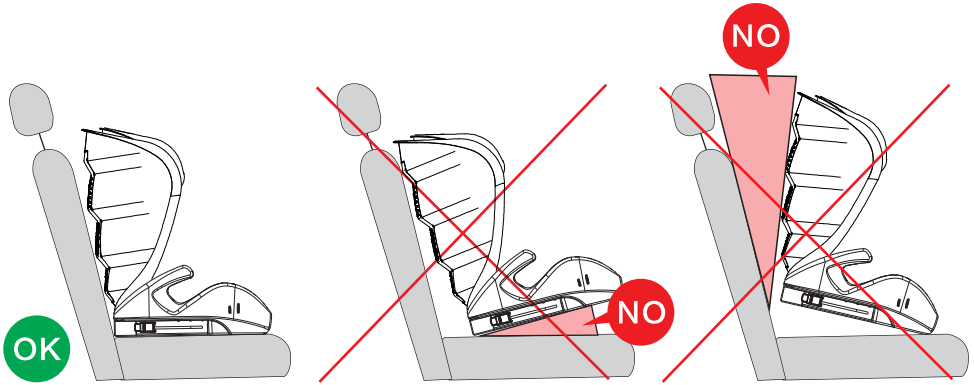

Check whether the safety seat is installed correctly. Proper installation is crucial to ensure the safety of children. The fixing of the safety seat must follow the instructions on the belting stickers located on both sides of the seat or the instructions in the manual.

Move the front seat as far forward as possible to ensure that the child's legs have a comfortable space for movement.

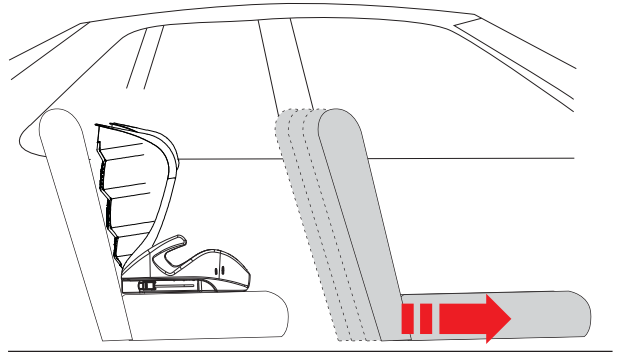

# KNOW YOUR ISIZE BOOSTER SEAT

---

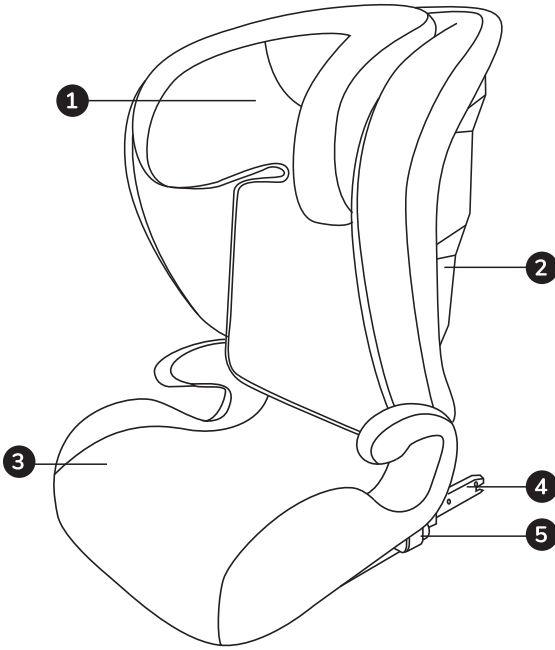

1. Headrest
2. Backrest
3. Base
4. ISOFIX connectors
5. ISOFIX button

# INSTALLATION IN THE VEHICLE

## Car belt+ ISOFIX installation

Applicable to vehicles equipped with ISOFIX system that meets the requirements of ECE R14

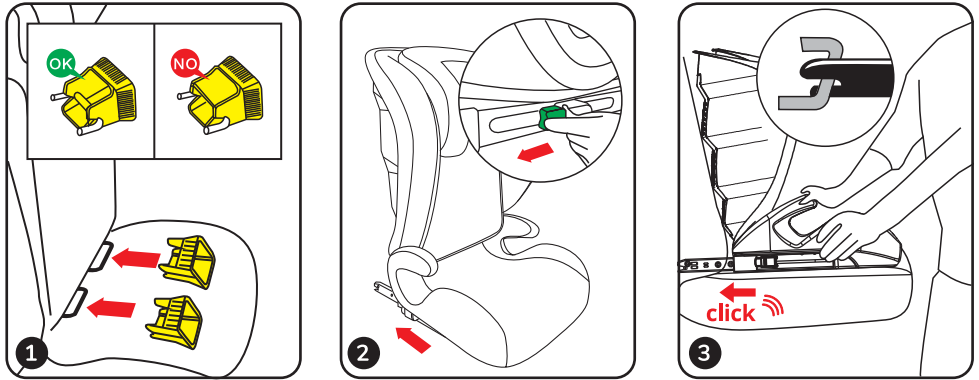

1. Find the ISOFIX fixed anchor points on the car and clip the two guide sleeves to the two ISOFIX fixed anchor points of the car to facilitate subsequent installation.
2. Press and hold the ISOFIX unlock button while sliding outwards to adjust the ISOFIX connectors on both sides of the safety seat to the longest state.
3. Connect the ISOFIX connectors of the safety seat to the ISOFIX anchor points of the car until you hear a "click" sound.

**Tip:** For the location of the ISOFIX fixed anchor point, please check your car's user manual or contact your car manufacturer or local dealer.

# INSTALLATION IN THE VEHICLE

## Car belt+ ISOFIX installation

Use three-point seat belts to secure children

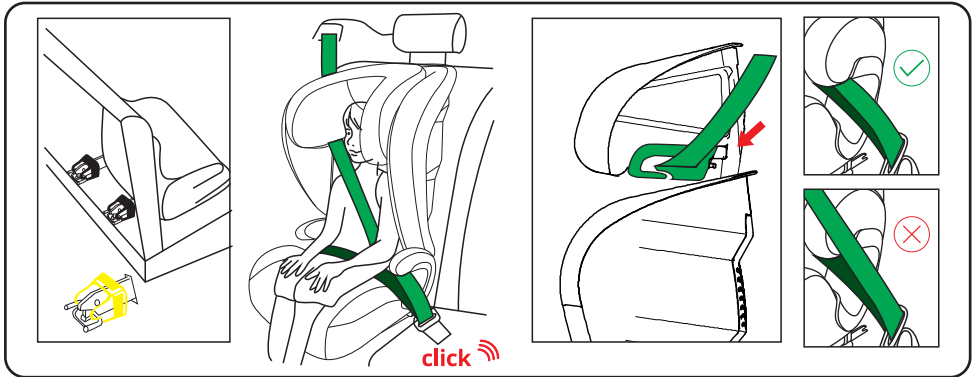

Pull out the vehicle's seat belt, pass it through the front of the safety seat, insert it into the buckle of the vehicle seat until you hear a "click" sound and make sure the vehicle seat belt is completely locked in. Then make sure the seat belt is locked into the green shoulder belt guide.

Please ensure that the lap strap is worn low down so that the pelvis is firmly engaged. Pull on the strap until it lies flat and is close against the child's body. The straps should be correctly adjusted and ensure they are not twisted.

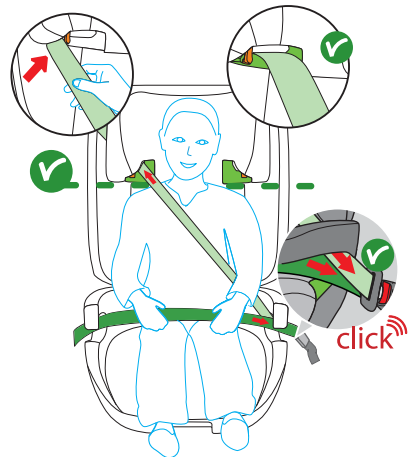

 The shoulder belt height should be slightly higher than the child's shoulder.

# INSTALLATION IN THE VEHICLE

## Car belt installation

Use three-point seat belt installation

Applicable to vehicles equipped with ISOFIX system that meets the requirements of ECE R14

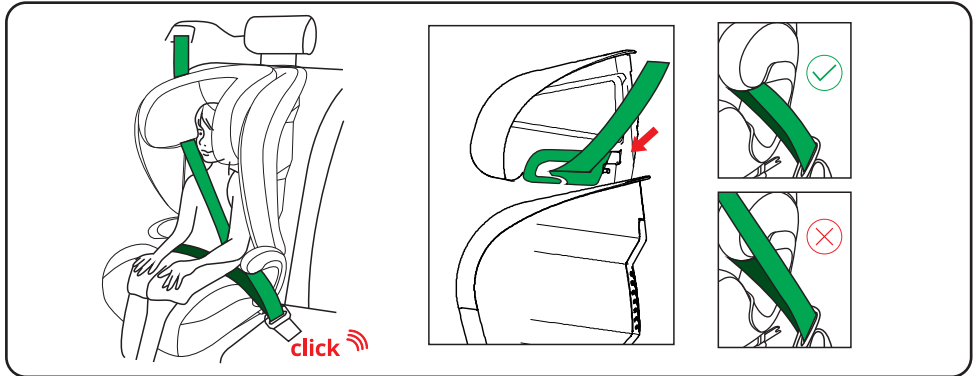

1. Ensure that the ISOFIX connectors of the safety seat are retracted into the base, and place the safety seat on the vehicle's seat.
2. Let the child sit on the safety seat and adjust the length of the safety belt guide hook according to the child's height.
3. Pull out the car's three-point safety belt, the shoulder belt of the safety belt passes through the guide hook and the top of the armrest. The abdominal belt of the safety belt passes through the guide grooves on both sides of the safety seat, and is fixed to the car buckle, and you hear "Click" sound to ensure that the buckle is firmly locked.
4. Tighten the car seat belt, adjusting the tightness of the car seat belt according to the size of the child. Please ensure that the lap strap is worn low down so that the pelvis is firmly engaged. Pull on the strap until it lies flat and is close against the child's body. The straps should be correctly adjusted and ensure they are not twisted.



The shoulder belt height should be slightly higher than the child's shoulder.

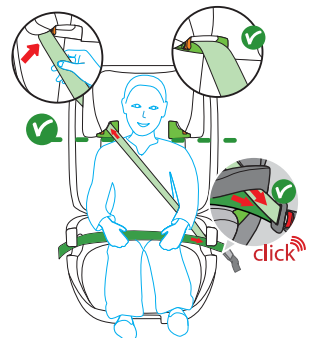



# INSTALLATION IN THE VEHICLE

## Headrest height adjustment

Pull up the handle of the seat headrest to adjust it up and down, release the handle to lock the headrest into position.

Note: Please ensure that the seat headrest is locked into position.

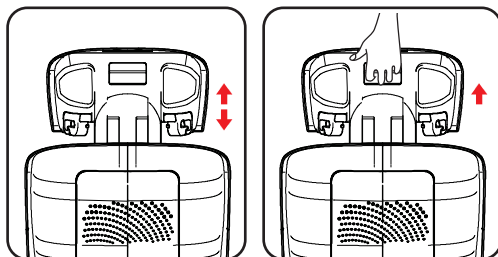

## Removing the Safety Seat

1. Press and hold the ISOFIX unlock buttons on both sides at the same time. The ISOFIX lock indicator will turn red means it is unlocked.
2. Pull the safety seat outwards to remove from the vehicle.

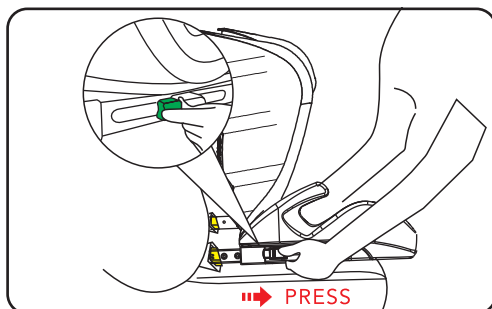

## Disassembly of the seat back and base

After laying down the seat, press the base with one hand and pull up the back of the chair with the other to separate the back of the chair from the base.

## Assembly of the seat back and base

Press the back of the chair downward to insert the back of the chair into the connecting shaft to combine the back of the chair with the base.

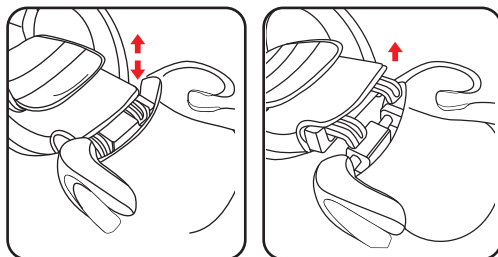

# CLEANING

---

Please be sure to use only original My Babiie replacement seat covers, as the seat cover is important to the proper functioning of the system. Replacement seat covers are available from My Babiie.



**The child seat must not be used without the seat cover.**

- The cover can be removed and hand washed at 30°C with a mild detergent. Please observe the instructions on the washing label of the cover. The colours of the cover may fade if washed at more than 30°C. Never tumble dry in an electric clothes dryer (the fabric may separate from the padding).
- The plastic parts can be cleaned using soapy water. Do not use harsh cleaning agents (such as solvents).
- The harness can be removed and washed in lukewarm soapy water.

# WARRANTY

---

For this child seat we provide a 1 year warranty against manufacturing or material defects. The warranty period is effective from the day of purchase.

**The Warranty does not cover:**

- Natural signs of wear and damage resulting from excessive stress.
- Damage resulting from inappropriate or improper use.

**What is covered by the Warranty?**

**Fabric:** All of our fabrics meet very high requirements with regards to colour fastness when exposed to UV radiation. Nevertheless, all fabrics fade when exposed to UV radiation. This is not a material defect, but rather a normal sign of wear which is not covered by the Warranty.

# MyBabiie®

For little people who dream big

## REGISTER YOUR PRODUCT AT

[www.mybabiie.com/warranties](http://www.mybabiie.com/warranties)

**In the first instance of needing assistance please  
contact your original place of purchase.**

This product qualifies for 12 month warranty  
when registered through our website

## STAY CONNECTED!



My Babiie



@MyBabiieOfficial



My Babiie



@mybabiie\_official

My Babiie Ltd  
Paddock Wood, Kent, TN12 6EN